

# HR Project & Data Manager

Human Resources Division

Closing Date: Monday 30 September 2024  
Job Reference: AH43243

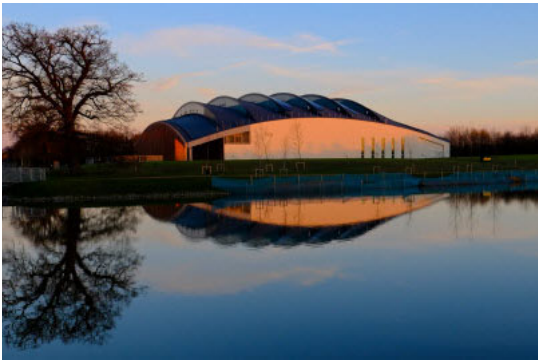

# The Role

**Salary:**  
£40,521—£54,395

**Contract:**  
Fixed term contract for 18 months

**Location:**  
The Old Schools,  
Central Cambridge

**Department:**  
Human Resources  
Division

**Responsible to:**  
HR Strategic Lead  
(Workforce Planning)

**Working Pattern:**  
Full Time

## Role Purpose

To work with managers and senior colleagues across the University to support the planning and implementation of strategic HR projects relating to engaging people on the most appropriate contractual arrangements.

To produce meaningful data and information that provides insight into relevant processes, behaviours, and trends to inform project decision making. This will include collating information from systems, feedback from departments and responding to queries.

## Key responsibilities

### 1) Project Management

- Scope, develop and implement project plans with key stakeholders to deliver project and organisational objectives.
- Identify and manage risks and monitor interdependencies.
- Work with key stakeholders to assist with process mapping and to deliver actions.
- Track delivery and provide updates on the progression of the project including the early identification of risks and mitigations.

### 2) Information

- Interrogate, collate, query, analyse and manage data from a wide range of sources (HR internal systems, Departmental information, Cognos, Data Marts, PowerBI, Qualtrics and other

analytics tools) for use in providing statistical information to support the project.

- Provide data advice to colleagues including legal obligations.
  - Research, identify, analyse and use other valuable sources of data and information (internal, external and benchmarking) for both quantitative and qualitative analysis.
  - Provide statistics, reports and information to working groups and Trade Unions.
- ### 3) Advising
- Assist with identifying and addressing the root cause of issues.
  - Advise on HR issues particularly employment law relating to contract types and status to assist with problem solving and the co-development of pragmatic solutions that are operationally viable within Departments.
  - Promote cultural change in Departments in how they engage their workforce by providing data analysis/ charts and HR advice on impact and alternative approaches, etc.



# The Role



- 4) Communication**
  - Develop and implement communication and change strategies.
  - Draft papers, communications and deliver presentations to inform and update stakeholders.
  - Build and develop strong working partnerships with key stakeholders including managers/departmental administrators, trade unions, colleagues and other key stakeholders
- 5) Line Manage**

Line manage a Projects Coordinator including setting objectives, allocating work, performance managing and supporting their development.
- 6) Maintain and develop own knowledge of systems, data management, HR best practice and other relevant knowledge bases to enhance professional capability.**
- 7) Actively participate in the broader work of the HR Policy and Strategic Projects Team.**





# Person specification

	Essential	Desirable
<b>Relevant experience</b>		
HR generalist professional with experience in the application of employment law, contract types, HR policies and organisational change.	✓	
Significant experience of working with data, compiling, analysing, interpreting large and complex data sets to produce meaningful reports, charts and graphs using Microsoft Excel.	✓	
Experience of undertaking data validation, and data reconciliation .	✓	
Experience of planning, coordinating and implementing complex projects .	✓	
An understanding of the challenges of implementing change within a large, complex institution.	✓	
Line management experience		✓
<b>Specialist knowledge &amp; skills</b>		
Excellent organisation skills to plan and manage projects (short, medium and long term), resources and own work to meet deadlines whilst managing competing priorities	✓	
Strong analytical skills using both qualitative and quantitative information to identify root cause at an operational level and develop a range of value adding solutions, thinking creatively and strategically.	✓	
Able to undertake research and collate information from a variety of sources relevant to the projects.	✓	
Confident in the use of systems including reporting tools e.g. Power BI, Excel.	✓	
Well-developed presentation skills (written and verbal) to produce and present clearly articulated, well structured, concise communications and reports for briefings, committee papers etc.	✓	
Strong communication skills with a collaborative approach and the ability to build and maintain effective working relationships at all levels to influence and get things done.	✓	
Understand the importance of confidentiality in an HR environment.	✓	
<b>Qualifications</b>		
Knowledge and understanding of HR processes and practices and understanding of HR systems.	✓	
Good understanding of the legal context of data requirements and good practice such as GDPR.	✓	
Strong Excel skills for data analysis and presentation.	✓	
Educated to a degree level or equivalent or equivalent qualification or quantifiable experience.		✓

# Behavioural Attributes

This section summarises the behavioural attributes (or competencies) that we expect the role holder to be able to demonstrate, at what level and whether this is an essential or desirable requirement. Full definitions are at: <https://www.hr.admin.cam.ac.uk/policies-procedures/behavioural-attributes>.

Please review these and provide specific examples in your application of how you have demonstrated these attributes in your work, education or other experience. It will assist your application if you explain the situation, what you did and what the outcomes were.

Attribute	Level
Valuing Diversity	A
Achieving Results	B
Communication	B
Innovation and Change	B
Negotiating and Influencing	C
People Development	B
Relationship Building	B
Strategic Focus	B

# Professional Services Values

Developed by professional services staff, our values underpin everything we do. By living the values in the work we do, we hope to foster an environment where staff feel empowered. The values encourage staff to; work together and share skills to create a sense of community, act with integrity, take an inclusive and fair approach and develop honest and open relationships that are underpinned by our shared values. We encourage applicants to consider these values within their application.



# Human Resources Division



**The Human Resources (HR) Division supports the University to deliver its goals of excellence in education, learning and research via the recruitment, retention, reward, recognition and development activities of our staff.**

Together with HR colleagues embedded in Departments, the staff of the Division form a University-wide HR community dedicated to ensuring that the University continues to maintain and enhance its reputation as a leading employer. Our people are the University's greatest asset and the Division is committed to attracting and developing talented individuals, working as a cohesive whole to ensure all staff are supported at all times during their careers at the University.

At the heart of the Division is the HR Business Partnering team, which pro-actively supports managers and senior leaders across all the University's academic and non-academic departments in achieving their people-related strategic goals.

Alongside the HR policies, procedures and guidelines in place throughout the full lifecycle of employment, the Division offers a wide range of HR services to staff, with teams providing specialist support, guidance and administration for a wide range of functions,

including but not limited to:

- Equality, Diversity and Inclusion
- Organisational Development
- Learning and Development
- Resourcing
- Reward
- HR Policy
- HR Shared Services and Analytics
- Postdoc Academy and Research Culture
- Childcare

In addition, the Division manages a diverse programme of strategic projects and initiatives, which may be short or long term in nature, but are usually complex, involve a broad range of topics, and make a significant impact at University and/or Department level.

A new overarching People Strategy is currently being developed. It will aim to ensure that the University is an employer of choice with a culture, policies and procedures that set high expectations, whilst providing a stimulating, inclusive and rewarding environment for its people and a competitive advantage to the institution.

# Terms of appointment

## Tenure and probation

The appointment will be made on a fixed-term basis for 18 months in the first instance to carry out a specific project of finite duration. Appointments will be subject to satisfactory completion of a probationary period which will be set dependant on the length of tenure.

## Hours of Work and Working Pattern

The hours of work for the position are full time.

## Pension

You will automatically be enrolled to become a member of USS (Universities Superannuation Scheme) – a defined benefits pension scheme. For further information please visit:

[www.pensions.admin.cam.ac.uk](http://www.pensions.admin.cam.ac.uk)

## Annual leave

Full time employees are entitled to annual paid leave of 41 days inclusive of public holidays. For new part-time employees, annual leave will be pro rata'd based on days worked.

## General information

### Pre-employment checks

### Right to work in the UK

We have a legal responsibility to ensure that you have the right to work in the UK before you can start working for us. If you do not have the right to work in the UK already, any offer of

employment we make to you will be conditional upon you gaining it.

### Health declaration

Once an offer of employment has been made the successful candidate will be required to complete a work health declaration form.

### Qualifications

The person specification for this position lists qualifications that are essential and/or desirable. Please note that if you are offered the post you will be asked to provide your relevant original certificates of these qualifications.

### References

Offers of appointment will be subject to the receipt of satisfactory references.

### Screening Checks:

This role requires a basic disclosure and security check. Any offer of employment we make to you will be conditional upon the satisfactory completion of these checks; whether an outcome is satisfactory will be determined by the University.

### Equality and Diversity

We particularly encourage candidates from a Black, Asian and Minority Ethnic background to apply for this vacancy as they are currently under-represented at this level within our University.

### Information if you have a disability

The University welcomes applications from individuals with disabilities. We are committed to ensuring fair treatment throughout the recruitment process. We will make adjustments to enable applicants to compete to the best of their ability wherever it is reasonable to do so and, if successful, to assist them during their employment. Information for disabled applicants is available at <http://www.admin.cam.ac.uk/offices/hr/staff/disabled/>

We encourage you to declare any disability that you may have, and any reasonable adjustments that you may require, in the section provided for this purpose in the application form. This will enable us to accommodate your needs throughout the process as required. However, applicants and employees may declare a disability at any time.

If you prefer to discuss any special arrangements connected with a disability, please contact, the Department Administrator, who is responsible for recruitment to this position.



# The University

**The University of Cambridge is one of the world's oldest and most successful universities. We are a renowned centre for research, education, and scholarship that makes a significant contribution to society. The University is consistently ranked amongst the top universities in the world. Our affiliates have won more Nobel Prizes than any other University.**

Our sustained pursuit of academic excellence is built on a long history of world-leading teaching and research within a distinctive collegiate system. For eight centuries our ideas and innovations have shaped the world. Our principal goal is to remain one of the world's leading universities in an increasingly competitive global higher education sector. Today the University of Cambridge is at the centre of a cluster of over 4,300 businesses employing 58,000 people.

Our capital investment projects include academic and commercial growth at both the West Cambridge Innovation District, and the Biomedical Campus in the south of the city. Eddington, in North West Cambridge, is a mixed-use development including key worker housing for staff, a community centre and a new primary school, managed by the University. Through these projects, the University is deeply embedded in, and committed to serving, our local community. These are all conspicuous signs of a University that is not only adapting to new needs, but also anticipating the future.

Our mission is to contribute to society through the pursuit of education, learning, and research at the highest international levels of excellence. Our core values are:

- freedom of thought and expression; and
- freedom from discrimination.

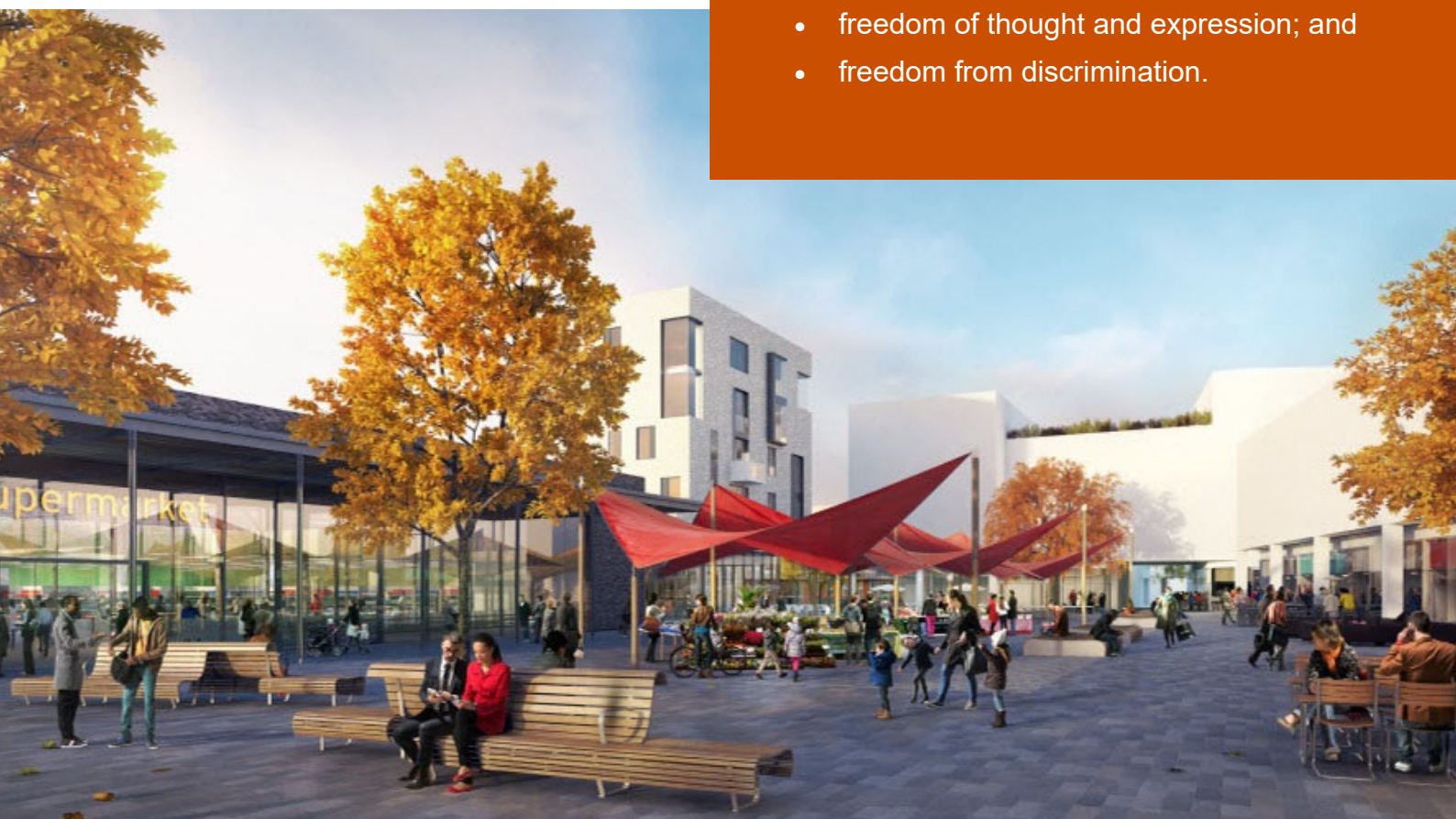



# About us

**The University is one of the world's leading academic centres. It comprises 150 faculties and departments, together with a central administration and other institutions. Our institutions, museums and collections are a world-class resource for researchers, students and members of the public representing one of the country's highest concentrations of internationally important collections.**

The University has an annual income of £2 billion. Research income, won competitively from the UK Research Councils, the European Union (EU), major charities and industry, exceeds £500 million per annum and continues to grow.

The Colleges and the University remain committed to admitting the best students regardless of their background and to investing considerable resources both in widening access and financial support. The 31 Colleges are self-governing, separate legal entities which appoint their own staff. Many academic staff are invited to join a College as a Teaching Fellow, which provides a further social and intellectual dimension. The Colleges admit undergraduate students, provide student accommodation and pastoral support and deliver small group teaching for undergraduates.

The University awards degrees and its faculties and departments provide lectures and seminars for students and determine the syllabi for teaching.

Our instinct for seeking out excellence and setting up enduring and mutually beneficial collaborations has led us to establish strategic partnerships across the globe. Whether it is the successful Cambridge-Africa Programme involving universities in Ghana, Uganda and elsewhere on the African continent; or the close association with the government of India to pursue new research in crop science; or the creation, with Germany's Max Planck Institutes, of a Cambridge-based centre for the study of ethics, human economy and social change – international partnerships are now an inextricable part of the University's make-up.

“Cambridge graduates and researchers have made – and continue to make – a colossal contribution to human knowledge and the understanding of the world around us. Their work touches on the lives and livelihoods of everyone from patients diagnosed with life-threatening diseases, to residents of areas critically affected by climate change, to children growing up in conflict zones. It has a lasting impact on our society, our economy and our culture: the world is truly a better place thanks to their efforts.”

*Stephen Toope, Vice Chancellor 2019*



# Working at the University

**Working at Cambridge you will join a diverse, talented and innovative community, with more than 23,000 students and over 16,000 staff from all walks of life and corners of the world.**

The University continually explores strategies to attract and retain the best people. It is committed to supporting its staff to achieve their best. We are a fair, diverse and inclusive society and we believe our staff are our greatest asset. There is strong commitment to developing institutional leadership and supporting and encouraging staff development at all levels.

We offer a variety of roles including academic, research, professional, managerial and support roles. We also offer extensive benefits and excellent learning opportunities within a stimulating working environment.

The University's estate is undergoing the most significant transformation in its history. Cambridge has been able to create a new science and technology campus to the west of the city centre, and is now expanding further to the north west of Cambridge including investing in affordable homes for University key workers and community facilities. Even with our continued development, the University remains within walking or cycling distance across the campus. The University is a major partner on the Cambridge Biomedical Campus and we continue to redevelop our historic city centre sites demonstrating our determination to ensure that we can offer the best facilities and opportunities for our staff and students.



## **Equality & diversity**

The University has built its excellence on the diversity of its staff and student community. We aim to be a leader in fostering equality and inclusion, and in promoting respect and a sense of belonging for all. We encourage applications from all sections of society. All appointments are made on the basis of merit. We have an Equal Opportunities Policy, along with a range of diversity groups, including the Women's Staff Network, Race Equality Network and LGBT+ Staff Network. More details are available here: <http://www.equality.admin.cam.ac.uk/>

The University has a bronze Race Equality Charter award, with a framework for improving the representation, progression and success of minority ethnic staff and students within higher education. Furthermore, the University's silver Athena swan award recognises and celebrates good practice in recruiting, retaining and promoting gender equality.



# Living in Cambridge

**Cambridge is rich in cultural diversity. From beautiful University and College buildings, museums and art galleries, quaint gardens and punts on the River Cam, to a vibrant restaurant and café scene, our employees are surrounded by the wonderful features of this unique city.**

You can find a wide-range of high street shops and 3 shopping centres, with independent alternatives at the historic market and nestled within the passageways in the city centre. You will find a cinema, bowling alley, a nightclub and various live performances at the Cambridge Leisure Park, with further entertainment options at the Corn Exchange, Arts Theatre and the ADC Theatre. Further information can be found on the [Visit Cambridge](#) website.

If you prefer the faster pace of life, London is a 45 minute train journey away. For those travelling from overseas, Stansted Airport is just 45 minutes away and Heathrow Airport under 2 hours away. The University is a short distance from a host of other attractions such as Ely Cathedral, Newmarket Races and various wildlife parks and stately homes. Cambridge is also within easy reach of the beautiful Broads and coastlines of Norfolk and Suffolk.



## Relocation Support

The University recognises the importance of helping individuals to move and settle into a new area. We provide support and guidance to those relocating internationally or domestically to take up a post at the University of Cambridge, liaising with other University offices and selected partners to ensure comprehensive relocation support is available. This includes: accommodation, childcare, schools, banking, immigration and transport. If you would like further information, please visit <https://www.accommodation.cam.ac.uk/RelocationService/>. The Shared Equity Scheme and the Reimbursement of Relocation Expenses Scheme provide financial assistance to qualifying new members of staff with the costs of relocating to Cambridge. For staff who require a Skilled Worker Visa, Global Talent Visa or Settlement (known as indefinite leave to remain) to take up employment with the University, we offer an interest free [visa loan scheme](#) for current and prospective staff (and their dependants), to help meeting the cost of obtaining a visa.

## Accommodation Service

The University Accommodation Service helps staff, students and visiting scholars who are affiliated to the University in their search for suitable accommodation in Cambridge. The dedicated accommodation team can provide access to a wide range of University-owned furnished and unfurnished properties, and has a database of private sector accommodation available for short and long-term lets. For further information and to register with this free service please visit <https://www.accommodation.cam.ac.uk/>



# What Cambridge can offer

**We offer a comprehensive reward package to attract, motivate and retain high performing staff at all levels and in all areas of work.**

The University offers a wide range of competitive benefits, from family leave entitlement, to shopping and travel discount schemes. Our generous annual leave package contributes to the positive wellbeing of our University employees. Sabbatical leave enables academics to focus on research and scholarship, whilst still maintaining their full salary. The University also has a [career break scheme](#) for academic and academic-related staff, with additional flexible working policies for all other staff.

## Pay and benefits

The University salary structure includes automatic service-related pay progression in many of its grades and an annual cost of living increase. In addition to this, employees are rewarded for outstanding contribution through a number of regular pay progression schemes. The University offers attractive pensions schemes for employees, with an additional benefit of a salary exchange arrangement providing tax and national insurance savings.



## CAMbens employee benefits

The University offers employees a wide range of competitive benefits, known as CAMbens. CAMbens offers something for everyone across a range of categories, including:

- Financial Benefits, including shopping discounts (both local and national) and a Payroll Giving scheme;
- Relocation and Accommodation Benefits, including relocation assistance and interest-free Rental Deposit Loans;
- Travel Benefits, including Cycle to Work, discounts on train season tickets and interest-free Travel to Work loans;
- Family Friendly and Lifestyle Benefits, including support with childcare and family friendly policies;
- Health and Wellbeing Benefits, including a University Staff Counselling Service, discounts at the University Sports Centre, and other local gyms, and healthcare schemes.



# What Cambridge can offer

## Family-friendly policies

The University recognises the importance of supporting its staff. We have a range of family-friendly policies to aid employees' work-life balance including a generous maternity, adoption and shared parental leave entitlement of 18 weeks full pay, and paid emergency leave for parents and carers.

Other family-friendly support includes:

Our highly regarded workplace nurseries, a childcare salary exchange scheme and a high quality holiday Playscheme may be available to help support University employees with caring responsibilities (subject to demand and qualifying criteria). Further childcare information can be found here: <https://www.childcare.admin.cam.ac.uk/>

The [Newcomers and Visiting Scholars Group](https://www.postdocacademy.cam.ac.uk/) is an organisation within the University run by volunteers whose aim is to help newly arrived wives, husbands, partners and families of Visiting Scholars and members of the University to settle in Cambridge and give them an opportunity to meet local people. The Postdoc Academy supports the postdoctoral community within Cambridge. Further details are available here: <https://www.postdocacademy.cam.ac.uk/>

## Your wellbeing

The University's Sport Centre, Counselling Services and Occupational Health are just some of the support services available to University employees to promote their physical and mental wellbeing. The University delivers The Festival of Wellbeing annually, which is a programme of stimulating talks and activities, which aim to promote wellbeing and good mental and physical health. The University also hosts the [Cambridge Festival](#), which is a great opportunity to get your first taste of public engagement, through volunteering, supporting hands-on activities or proposing a talk.

## Development opportunities

We support new employees to settle in through various activities as well as supporting their professional and career development on an ongoing basis. Our Personal and Professional Development (PPD) team provide development opportunities for all University employees, including face-to-face sessions, online learning modules and webinars. All employees also have unlimited access to LinkedIn Learning to support their development. Both new and existing employees can undertake funded Apprenticeships, which lead to a range of vocational and professional qualifications. We offer reduced staff fees for University of Cambridge graduate courses and the opportunity to attend lectures and seminars held by University departments and institutions. A range of University training providers also offer specialist learning and development in their own areas e.g. teaching and learning, digital literacy, finance, health and wellbeing, safety.





# How to apply

Applications should be submitted online via the University of Cambridge jobs page [www.jobs.cam.ac.uk](http://www.jobs.cam.ac.uk) by clicking “Apply online” in the job advert. You will need an email address to register for our online system.

Please ensure a CV and supporting letter is uploaded with your application

The University of Cambridge is committed to supporting our staff to thrive both professionally and personally. We aim to support a good work/life balance, whilst retaining the positive aspects of our unique in-person environment and culture. Elements of this role are suitable for hybrid working, where staff can split their time between in-person collaboration and remote working. The frequency of the remote elements of the role can be discussed with the recruiting manager.

Conversations about flexible working are encouraged at the University of Cambridge. Please feel free to discuss flexibility prior to applying (using the contact information below) or at interview if your application is successful.

Informal enquiries are welcomed and should be directed to:

Anne Pollintine, HR Strategic Lead Workforce Planning

**Email:** [anne.pollintine@admin.cam.ac.uk](mailto:anne.pollintine@admin.cam.ac.uk)

If you have any queries regarding the application process please

**Email:** [hrdivisionaladmin@admin.cam.ac.uk](mailto:hrdivisionaladmin@admin.cam.ac.uk)

The closing date for applications is: **Monday 30 September 2024**

Interviews will be held: **W/C Monday 14th October 2024**